

## Rear Spring Assembly – Remove and Install (one side) (15 621 0)

### Special Tools

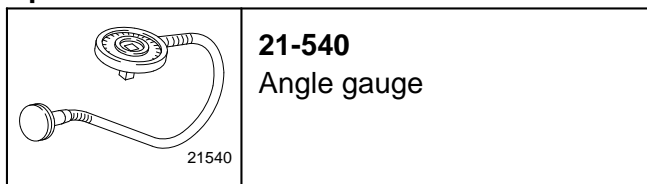

### Workshop Equipment

Trolley jack	
Transmission jack	

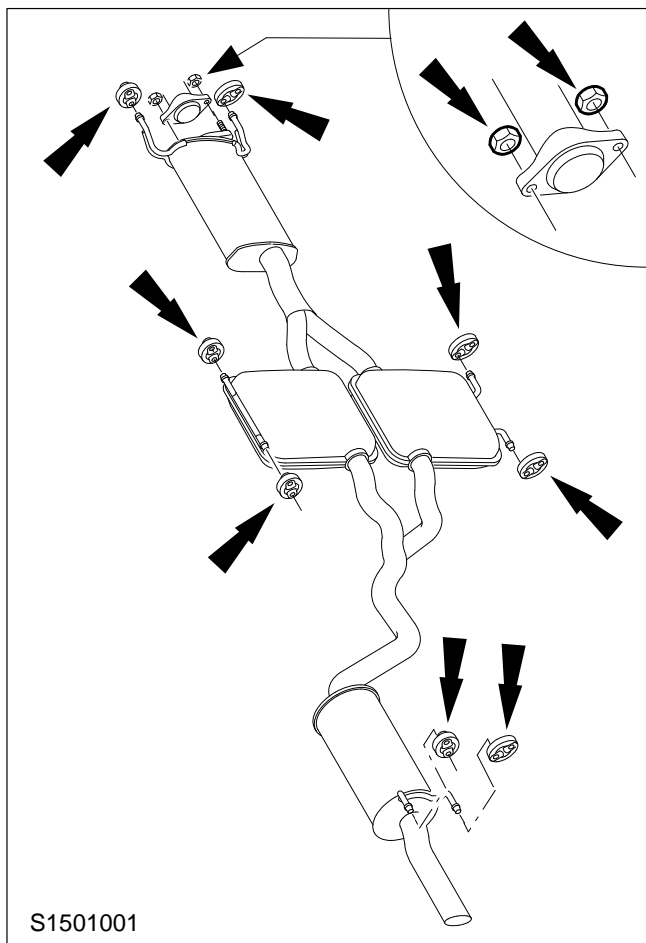

### Remove

#### 1. Remove the rear part of the exhaust system.

- Raise the vehicle.
- Disconnect the exhaust system at the middle flange (two bolts).
- Unhook the rear part of the exhaust system from the rubber mountings and lay it to one side.

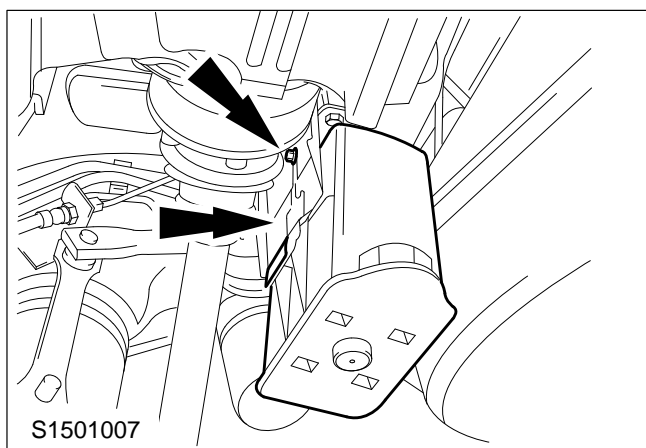

Petrol-engined variants only

#### 2. Detach the EVAP canister.

Loosen the bolt on the bracket, unhook the EVAP canister and tie it up to one side.

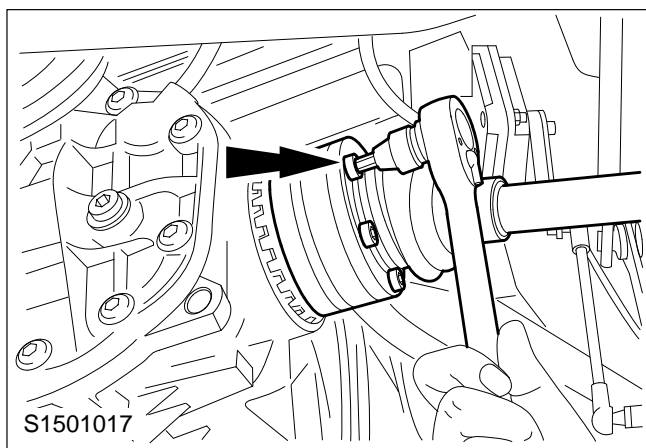

**3. Detach the rear axle driveshafts from the differential (vehicle shown built up to Jan '95).**

- Unscrew the bolts.
- Tie the rear axle driveshafts up to one side.
- Remove the seals.

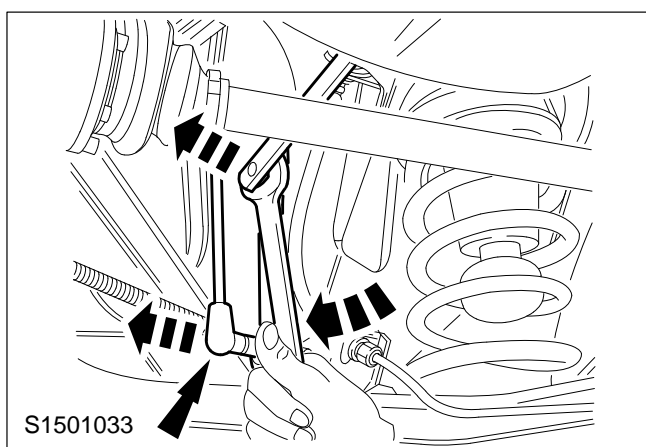

**NOTE:** Also detach the ball coupling when self-levelling suspension is fitted.

**4. Detach the stabiliser bar from the linkage at the top.**

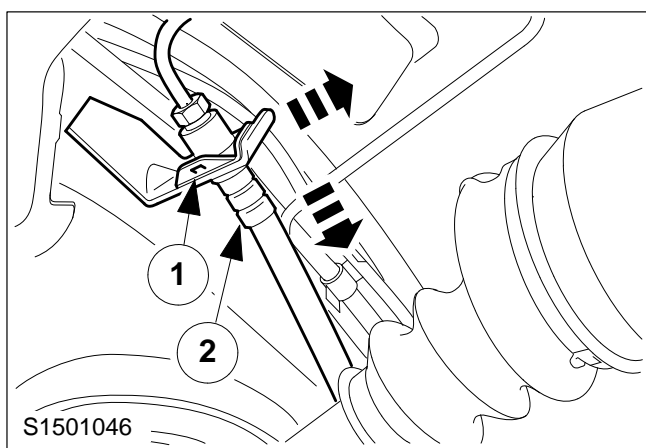

**5. Detach the brake pipe from the bracket and unclip it from the floor assembly.**

- 1 Prise out the U-shaped retainer.
  - 2 Release the brake pipe and hose.
- Unclip the ABS sensor wiring at the crossmember (three clips).

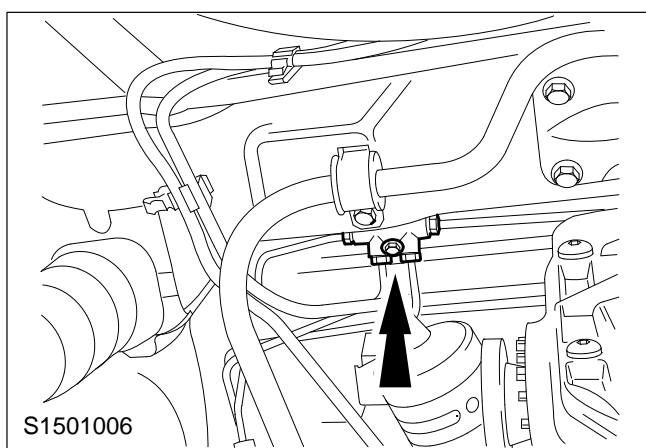

**NOTE:** For the left-hand spring only

**6. Unscrew the brake pipe distribution piece from the floor pan.**

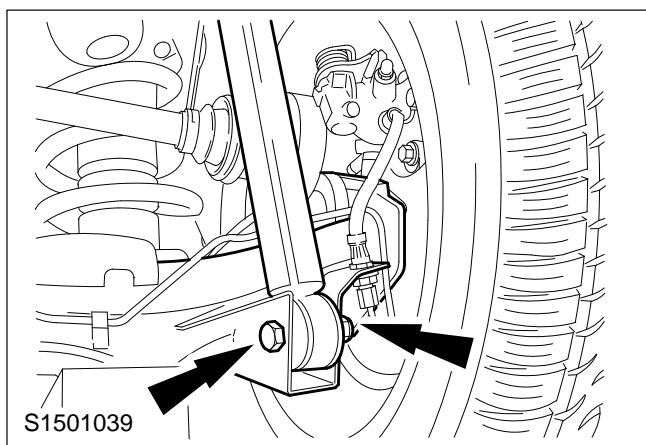

Saloon only

- 7. Support the rear axle crossmember, keeping the spring under load.**
- 8. Detach the shock absorber from the rear axle crossmember.**

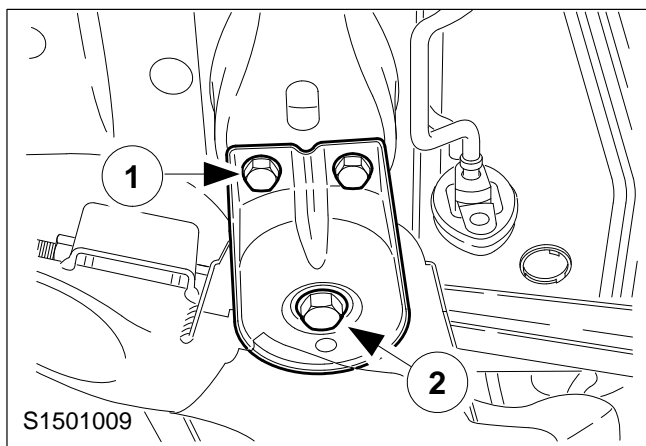

Saloon only

- 9. Detach the crossmember guide plate.**
- 10. Lower the crossmember.**
- 11. Remove the rear spring from the vehicle.**

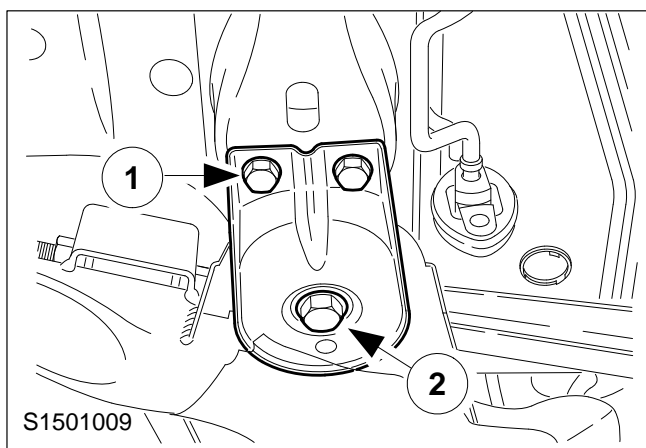

Estate only

## 12. Guide plate bolts and studs

**NOTE:** Sufficient space must be left to detach the shock absorber at the bottom.

## 13. Lower the vehicle to a suitable height and detach the guide plate.

- Support the rear axle crossmember on a trolley jack.
- Unscrew the guide plate.

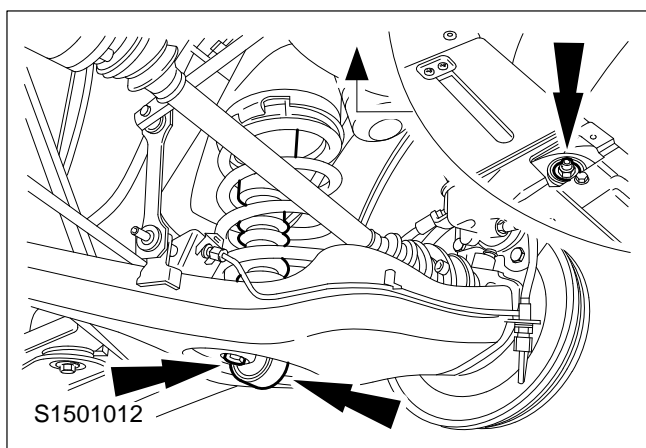

Estate only

## 14. Detach the shock absorbers from the body at the top.

- Pull the load space carpet to one side and remove the cover.
- Unscrew the nut and remove it with the washer.

## 15. Unscrew the shock absorber from the rear axle crossmember.

## 16. Remove the rear spring.

Lower the rear axle crossmember and remove the spring through the wheelhouse.

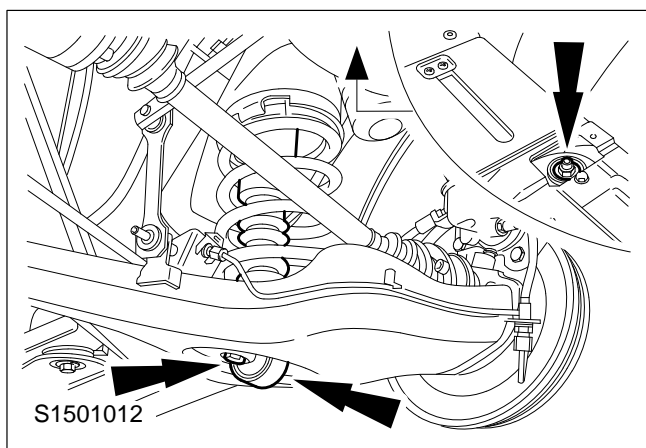

Estate only

**17. Unscrew the shock absorber at the top.**

- Move the load space carpet to one side and remove the cover.
- Unscrew the nut and remove it with the washer.

**18. Unscrew the shock absorber from the rear axle crossmember.**

**19. Remove the rear spring.**

Lower the rear axle crossmember and remove the spring through the wheelhouse.

Install

**NOTE:** Make sure that the rear spring is seated correctly in the rubber cup and the guide sleeve in the floor assembly.

**20. Locate the rear spring in position.**

Raise the rear axle crossmember.

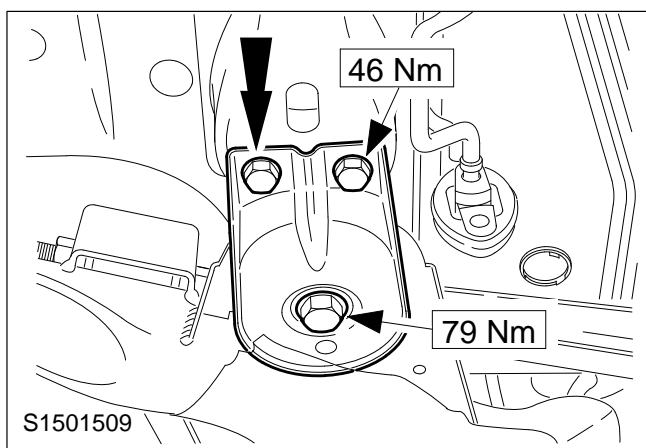

Saloon only

**21. Fit the crossmember guide plate.**

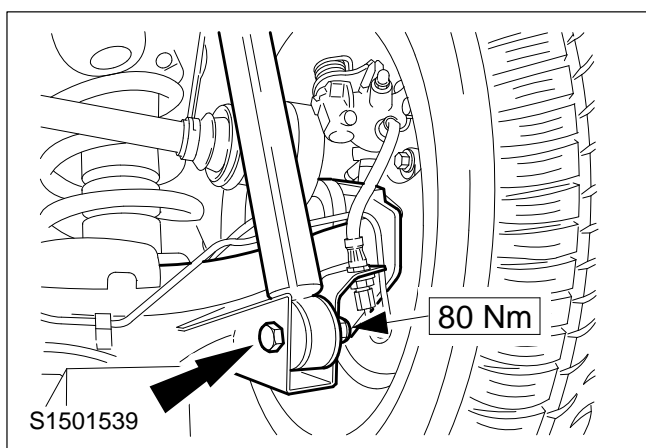

Saloon only

**22. Raise the crossmember to place the spring under tension.**

**23. Attach the shock absorber to the crossmember.**

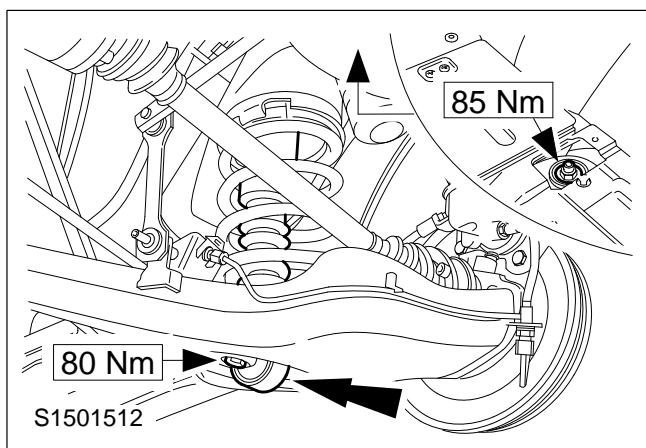

Estate only

**NOTE:** Make sure that the rear spring is seated correctly in the rubber cup and the guide sleeve in the floor assembly.

**24. Insert the rear spring.**

**25. Raise the rear axle crossmember with the trolley jack.**

**26. Secure the shock absorber at the bottom.**

**27. Secure the shock absorber at the top (washer and nut).**

Refit the cover and re-lay the carpet.

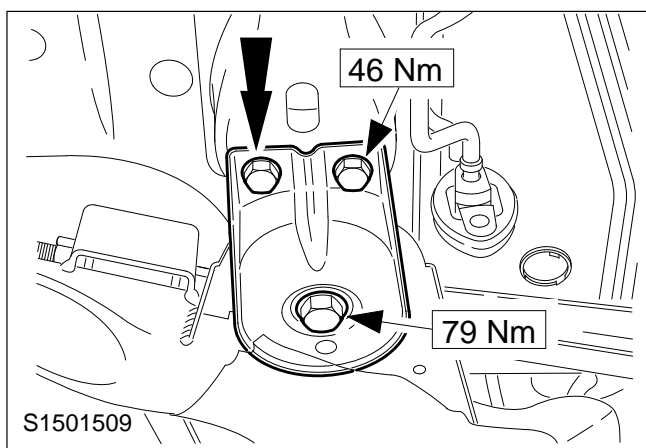

Estate only

**28. Fit the guide plate.**

- Lower the rear axle crossmember and remove the trolley jack.
- Raise the vehicle.

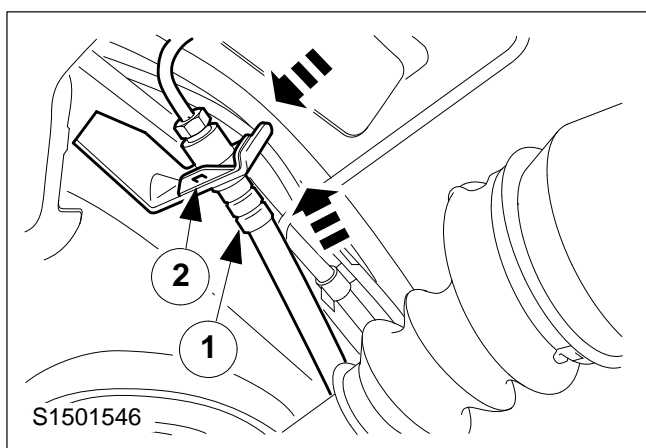

**29. Secure the brake pipe to the bracket on the bodywork.**

- 1 Attach the brake pipe and hose.
  - 2 Secure the brake pipe with the U-shaped retainer.
- Clip the ABS sensor wiring onto the crossmember (three clips).

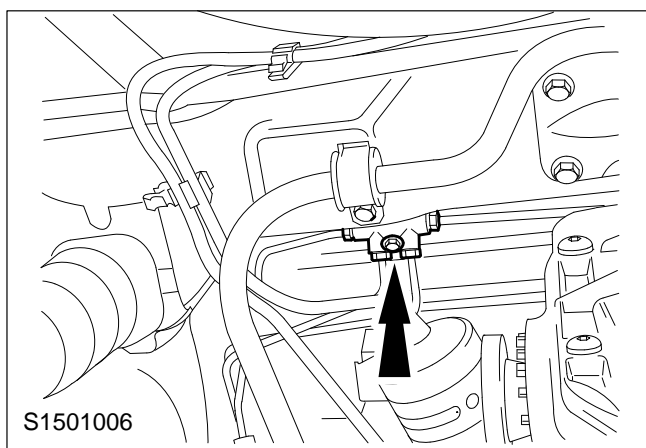

For the left-hand spring only

**30. Screw the brake pipe distribution piece to the floor pan.**

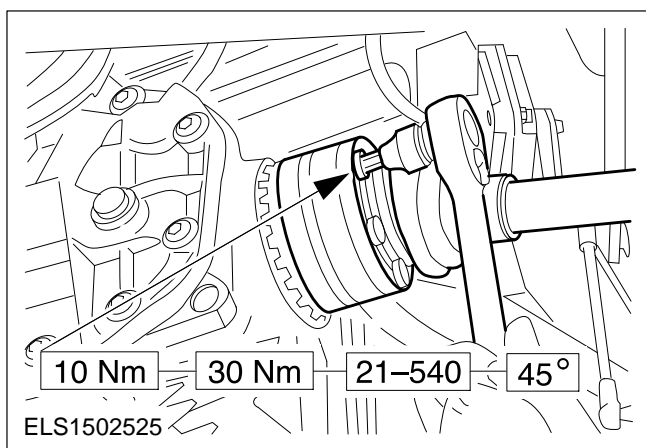

**⚠ CAUTION:** The torque varies according to the diameter of the bolt. The specified torque for the wheel and driveshaft side applies to M8 bolts.

**NOTE:** Fit new bolts. Place a new seal in the turned recess in the constant-velocity joints.

**NOTE:** Check the amount of grease in the joints and correct as necessary (WSD-M1C237-A), (90 g per joint).

**31. Fit the rear axle driveshafts with the M8 bolts (vehicle shown built up to Dec '95).**

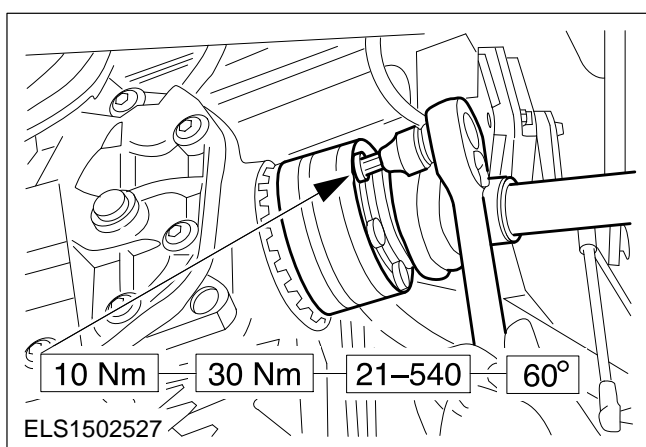

**⚠ CAUTION:** The torque varies according to the diameter of the bolt. The specified torque for the wheel and driveshaft side applies to M10 bolts.

**NOTE:** Fit new bolts. Place a new seal in the turned recess in the constant-velocity joints.

**NOTE:** Check the amount of grease in the joints and correct as necessary (WSD-M1C237-A), (90 g per joint).

**32. Fit the axle driveshafts with the M10 bolts (vehicle shown built up to Dec '95).**

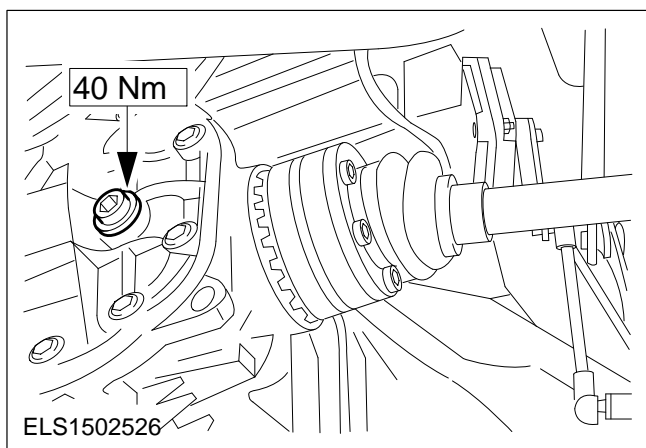
**33. Check the oil level in the differential.**

The differential should be filled with oil to the lower edge of the check bore.

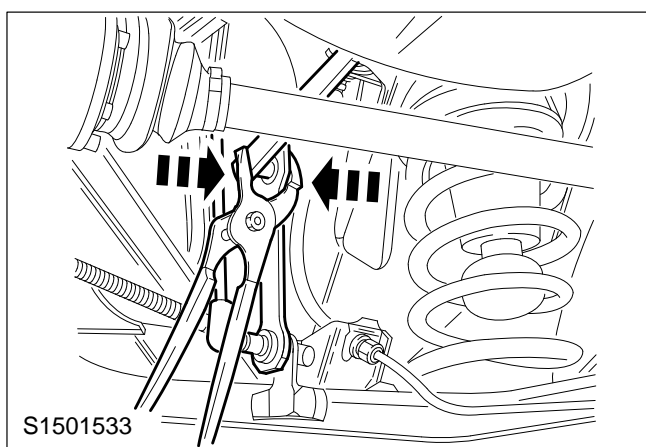

**NOTE:** Attach the ball coupling to the linkage when self-levelling suspension is fitted.

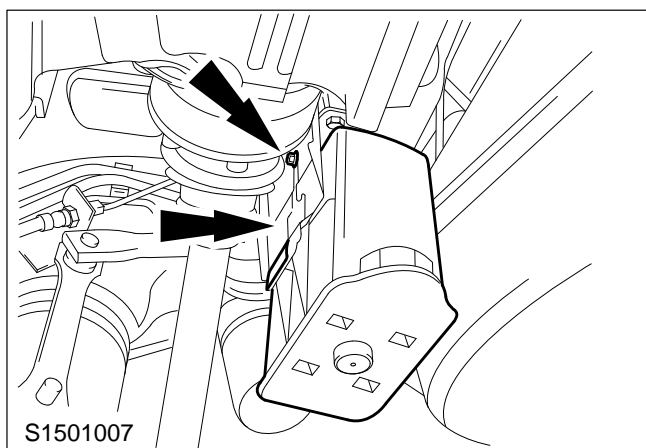
**34. Attach the stabiliser bar to the linkage.**

Petrol-engined variants only

**35. Fit the EVAP canister.**

Hook the EVAP canister into the bracket and tighten the bolt.

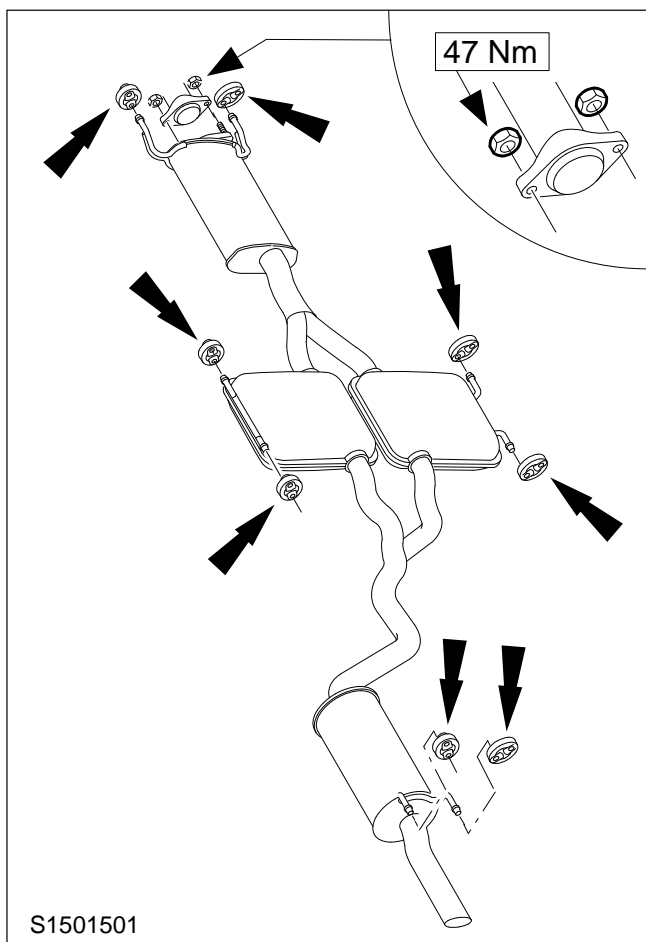

**36. Fit the rear part of the exhaust system.**

- Connect the pipe flanges, align the system and tighten the bolts.
- Hook the exhaust system into the rubber mountings.

**37. Lower the vehicle.**